

# Stadium District Master Plan

KICK-OFF MEETING 9.28.18



STADIUM DISTRICT



ARCHITECTURE | DESIGN



# Agenda

- ▶ Introductions
  - ▶ Clark County, RAFI, UNLV
- ▶ Scope
- ▶ Stadium District Boundaries
- ▶ Examples of other Areas
- ▶ Vision
- ▶ Projected Land Use
- ▶ Feedback
- ▶ Engagement



STADIUM DISTRICT

# Scope

- ▶ Prepare a Stadium District Master Plan as a recommendation to guide future land use
- ▶ Co-creating a community-driven vision for the Stadium District
- ▶ Master planning for land use improvements to support vision
- ▶ Making recommendations for the future





# District Boundaries

North boundary is Tropicana

West and South is the Railroad

East is I-15

1.23 square miles

787 acres



STADIUM DISTRICT

# Examples of other Arenas & Stadium designs reviewed

Sacramento,  
CA

Glendale, AZ

Minneapolis, MN

Philadelphia,  
PA

Arlington, TX

Detroit, MI

St Louis, MO

Kansas City,  
MO

Denver, CO

Boston, MA

# Golden 1



# Golden 1

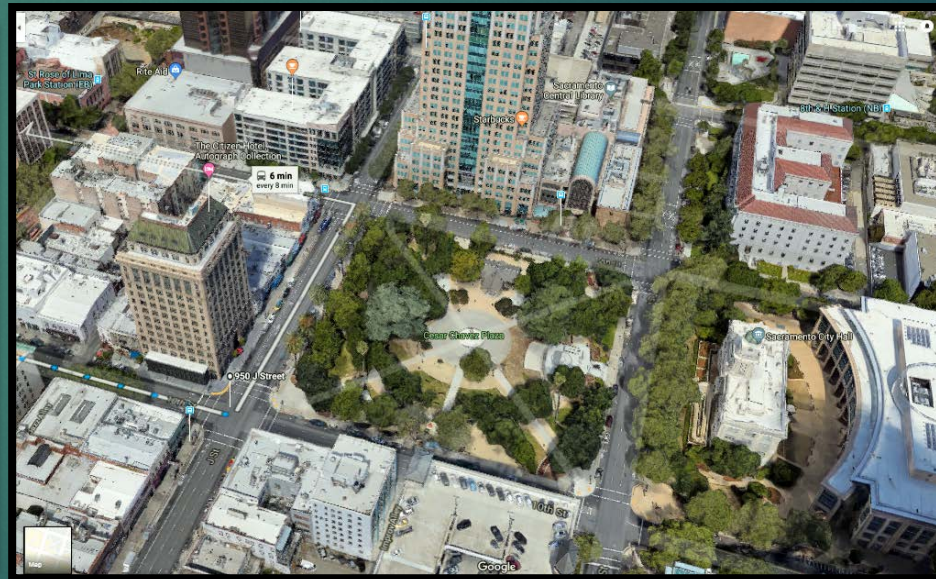
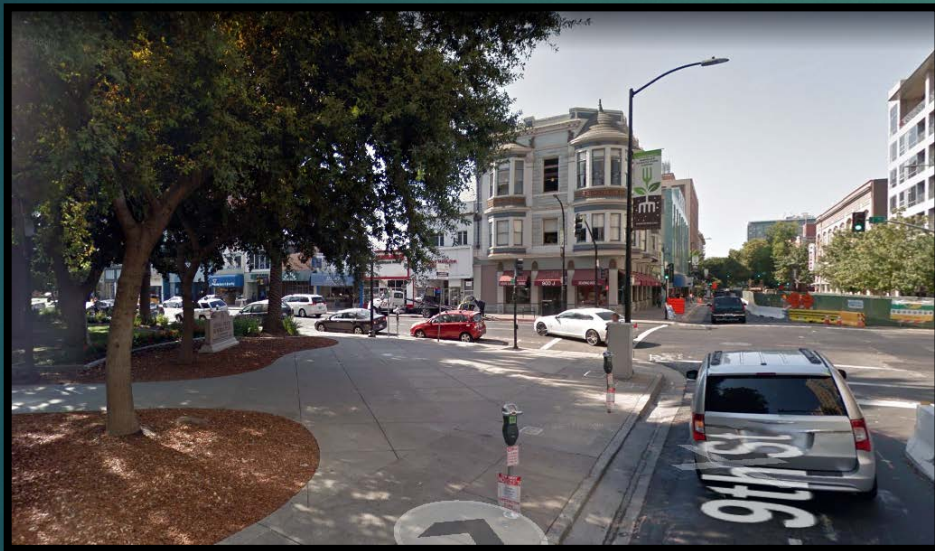

# Denver





# Philadelphia Sports Complex

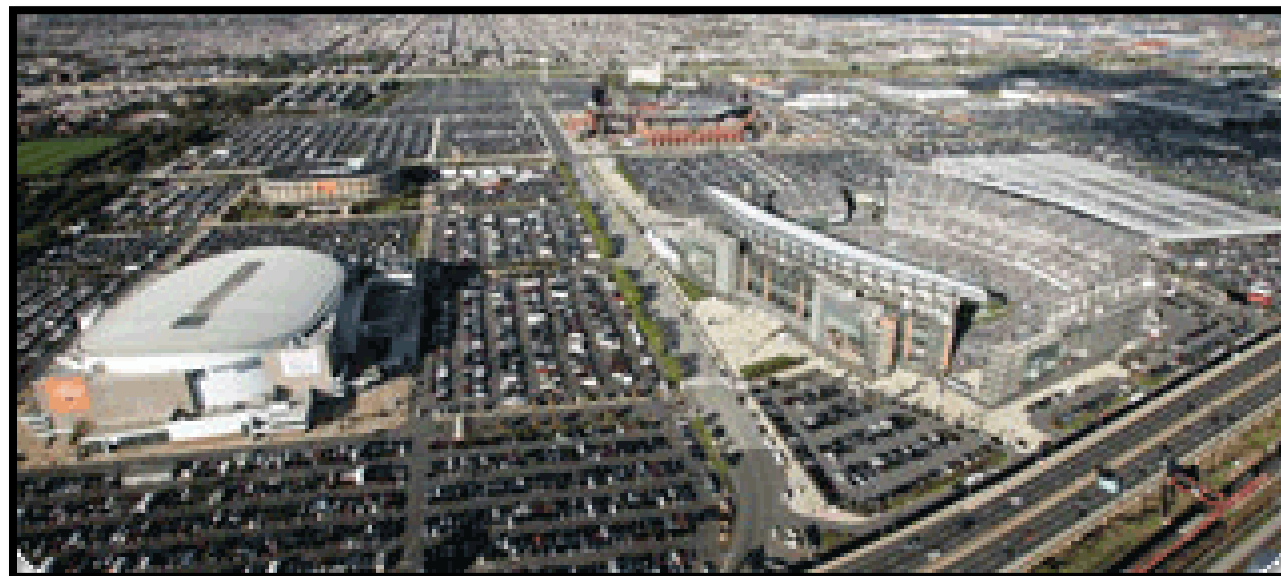
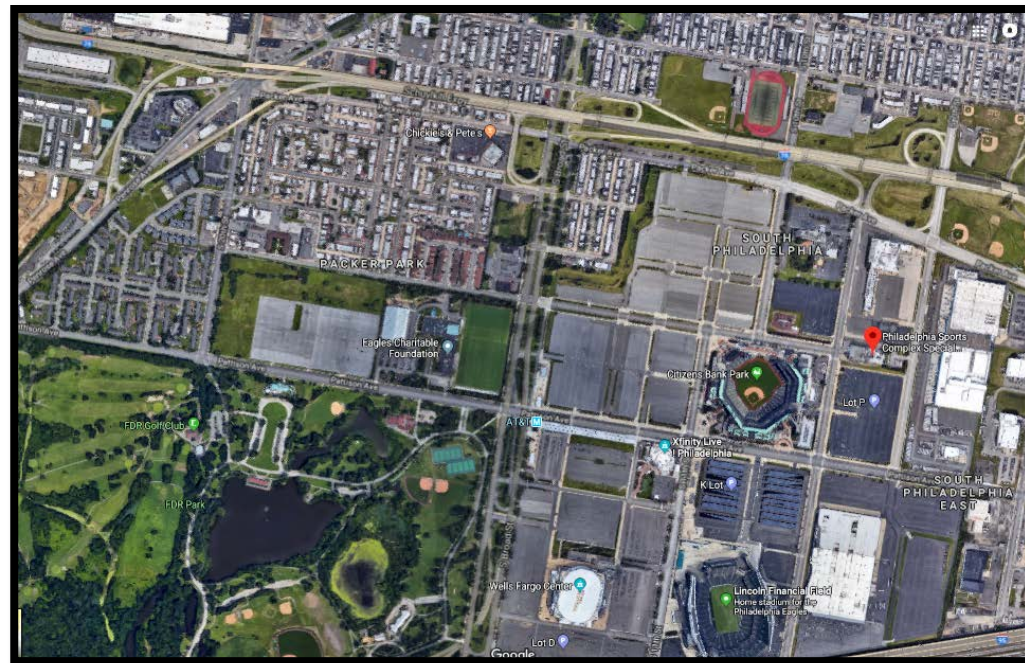



# University of Phoenix



# U.S. Bank Stadium

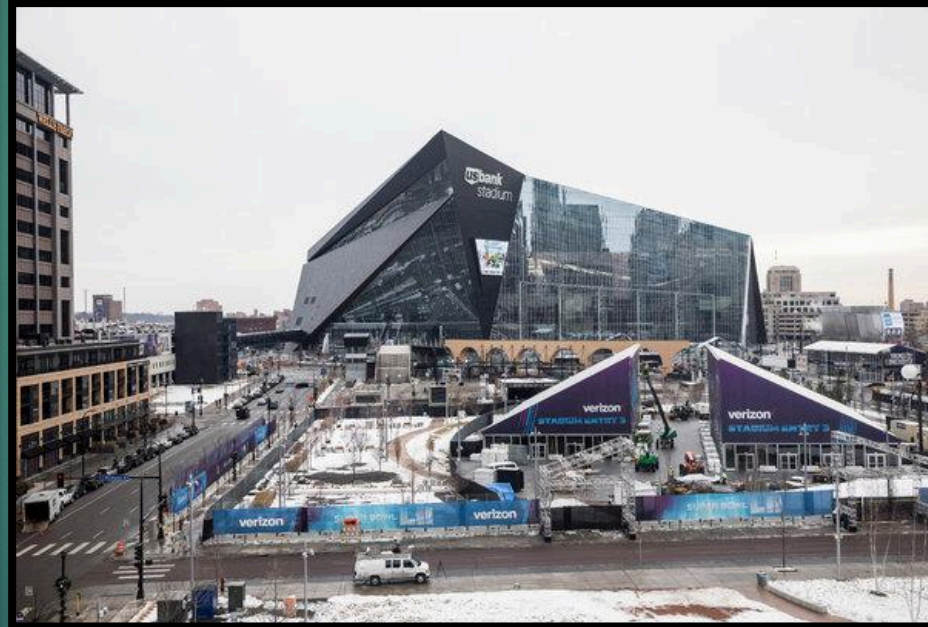

# AT&T and Texas Live!

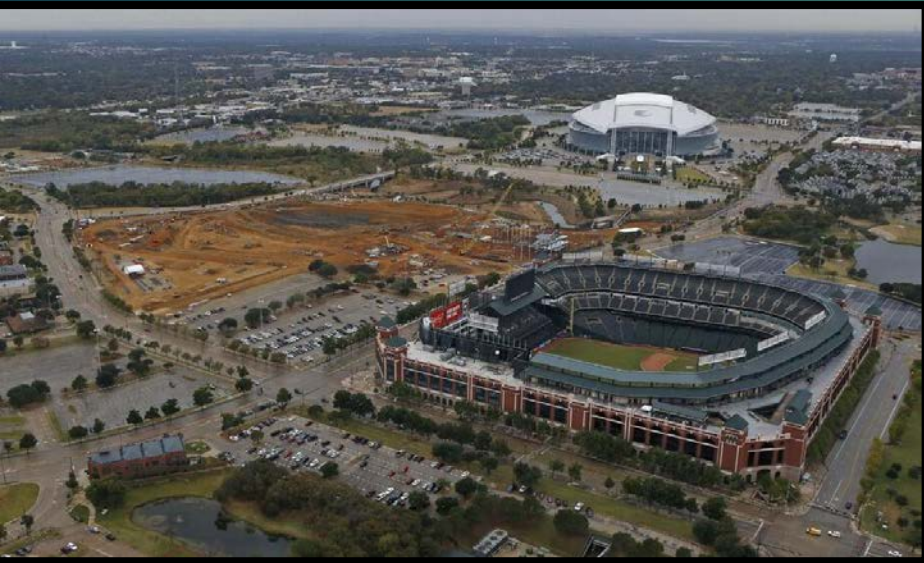

BALL **bp** PARK  
ESTATES

# The District in Detroit

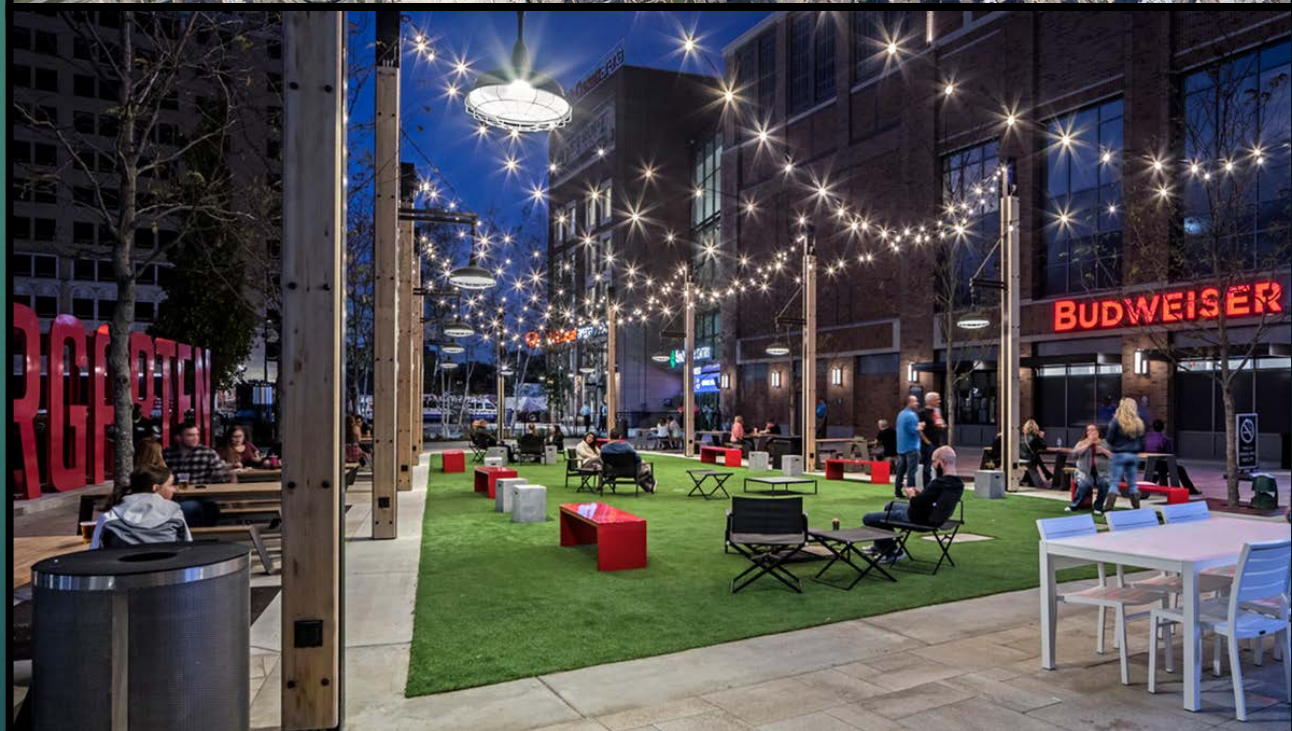
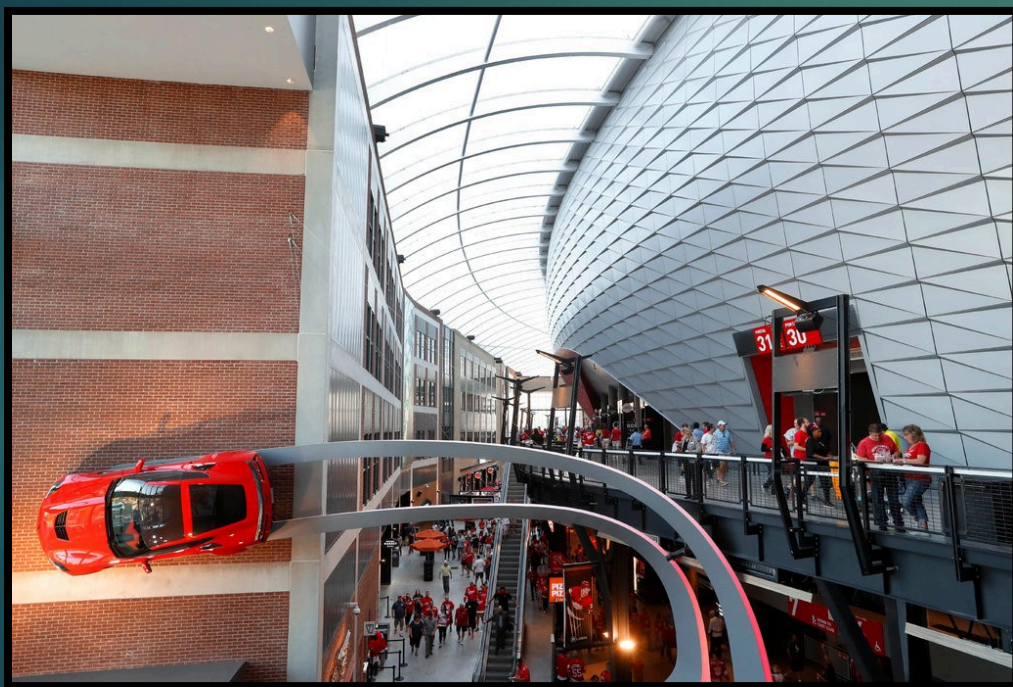

# Kauffman Stadium



# St. Louis Ballpark Village



# Images of the District currently

URBAN FORM AND STREET NETWORK



STADIUM DISTRICT



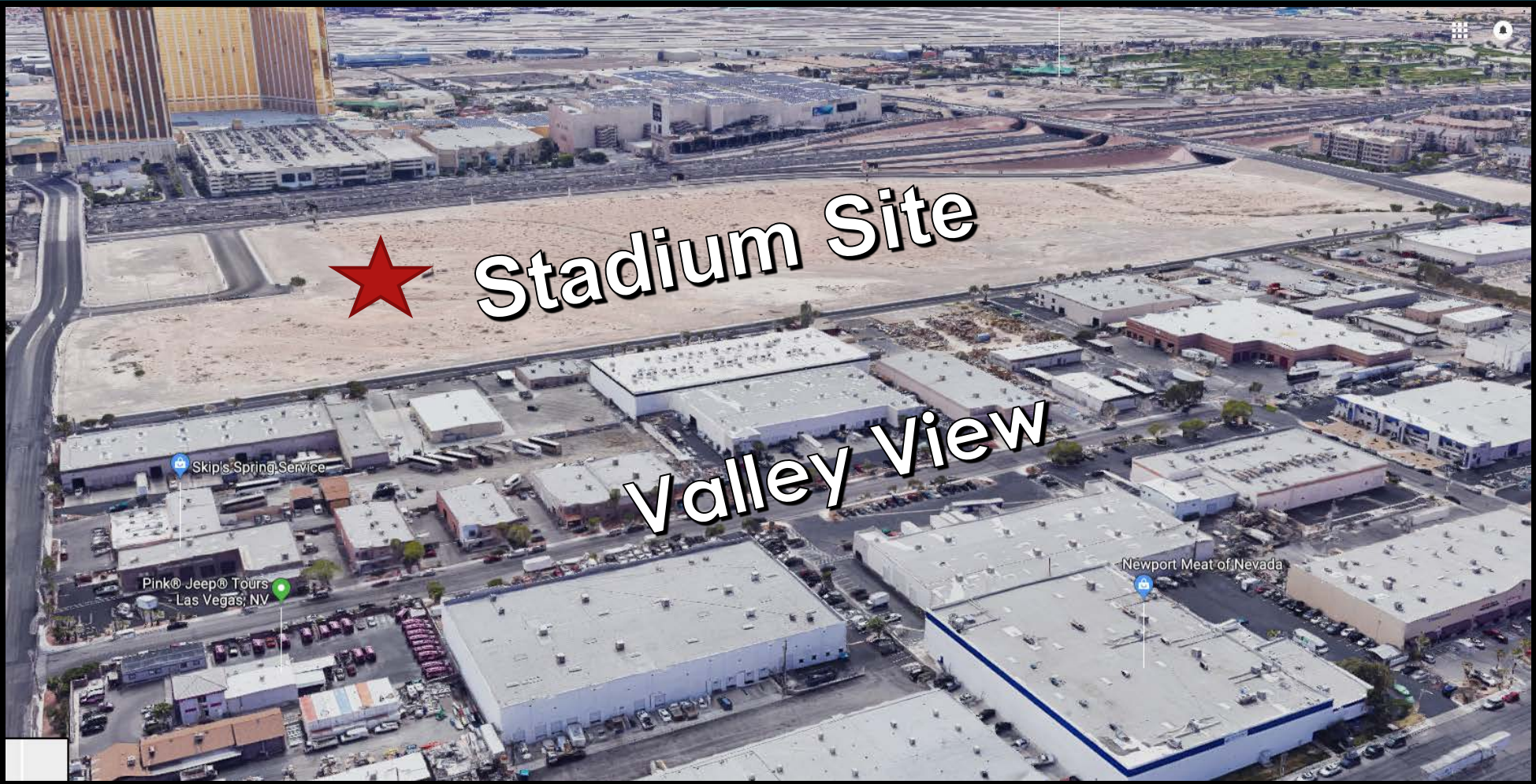

★ Stadium Site

Valley View

Skip's Spring Service

Pink Jeep Tours  
Las Vegas, NV

Newport Meat of Nevada



Tropicana

Stadium  Site

Railroad



Tropicana

Valley View



Pink & Jeep® Tours  
- Las Vegas, NV

Google

Google Camera: 1,032 m 36°05'46"N 115°10'38"W 654 m 100



Stadium Site

I-15

Google



# Vision



**Community**

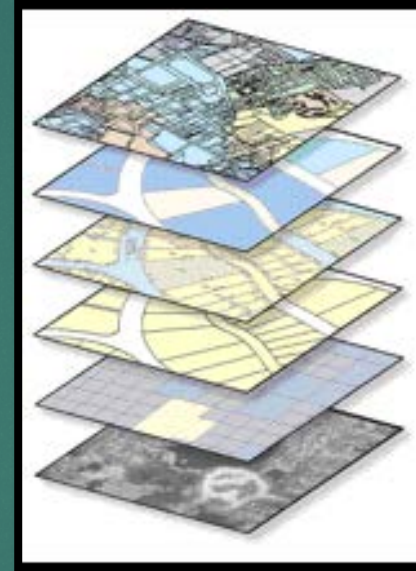

**Planning  
Tools**



# Vision Draft

A unique, high quality living and visitor experience within a comprehensive mix of land uses that advances Clark County as a global community and world attraction for entertainment, hospitality, business and sports.



# Planned Land Use

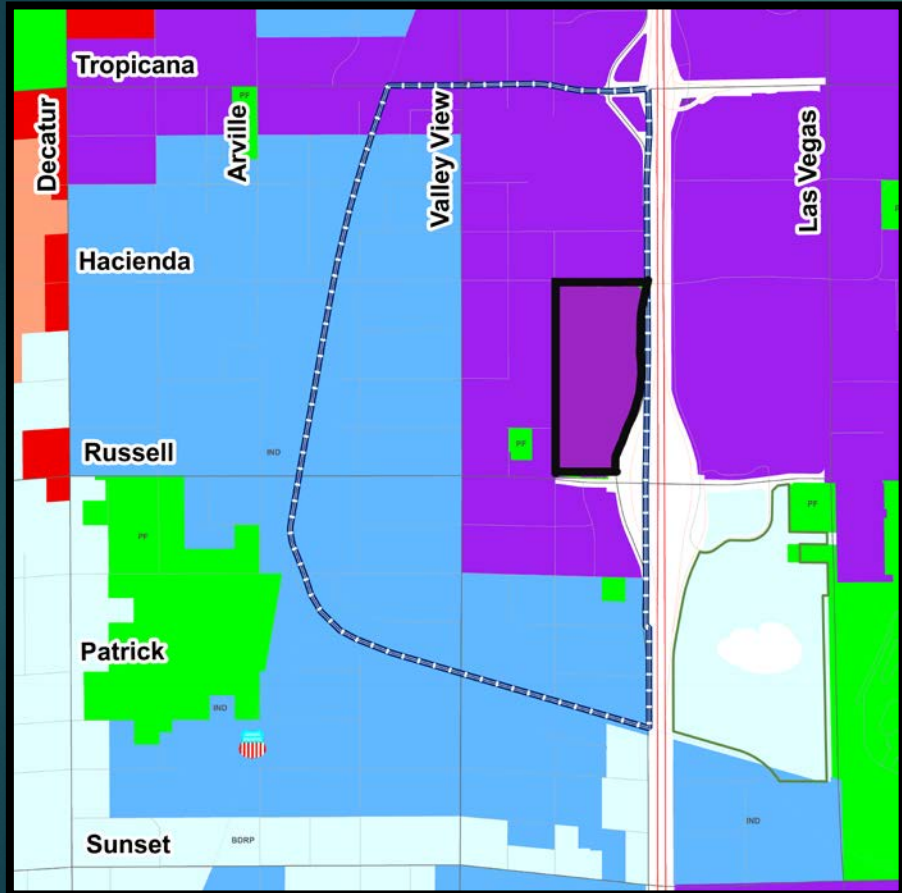

## Legend

-  Commercial Tourist
-  Commercial General
-  Industrial
-  Public Facilities
-  Residential High
-  Business & Design Research Park







STADIUM DISTRICT

# Mixed Use District (current)



Density as approved



Up to 50 du/ac



Up to 32 du/ac

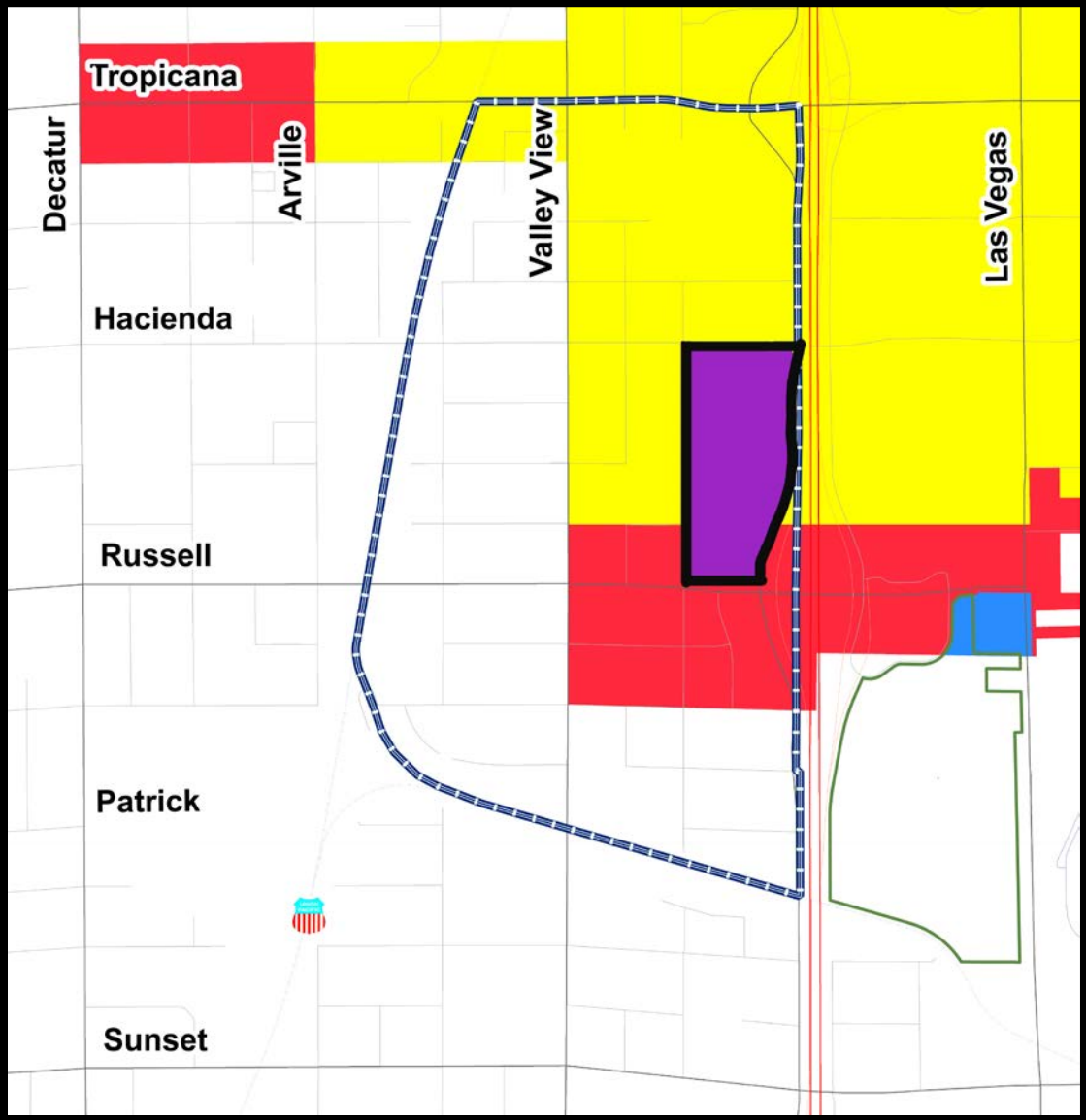

# Stay connected!

Please fill out one of our paper forms for providing any input today!  
Your voice will ensure the successful creation of the Stadium District Master Plan!

For more information,  
and to share your comments, please visit us online:

<https://tinyurl.com/ycrzonu5>



STADIUM DISTRICT

ARCHITECTURE | DESIGN

# Homework Assignment

- ▶ If you wish us to **contact your tenant** or anyone else, please provide us with their email info and/or give them our web site info, and have them contact us!
- ▶ How would you like to **craft this vision**? What matters to you?
- ▶ What would you like to **name** the District?



Thank you for your  
attendance.  
Stay involved so we can  
build a vision together!

by Museum

Pro Collision

Auto Body Shop