

## Township 28 South, Range 63 East Southeast Quarter

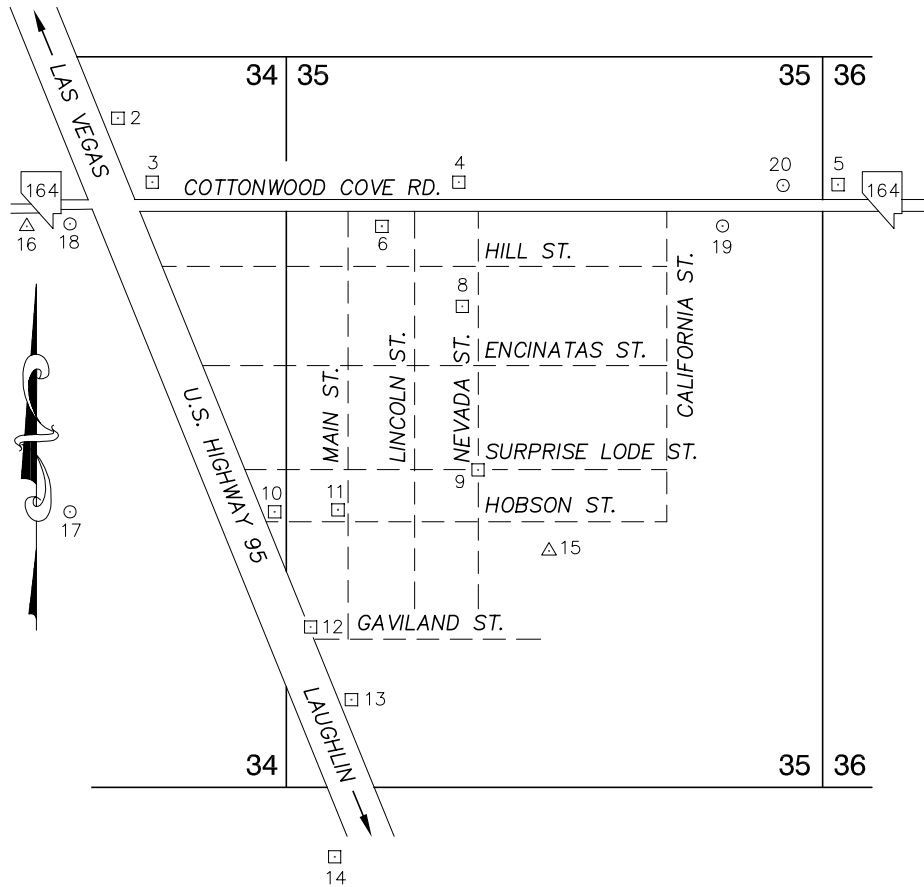

NORTH AMERICAN VERTICAL  
DATUM OF 1988  
- ALL ELEVATIONS IN METERS -

No.	STATION	ELEVATION (METERS)		DESCRIPTION
1				LOST 2003
2	6C83 34NEE6	1082.295	F N D	RIVET AND SQUARE ALUMINUM PLATE IN TOP OF CURB, EAST SIDE OF HIGHWAY #95 IN FRONT OF A CLOSED GAS STATION, 470' NORTH OF COTTONWOOD COVE ROAD.
3	6C83 34E6	1080.465	F N D	RIVET AND SQUARE ALUMINUM PLATE IN TOP OF CURB, NORTHEAST CORNER OF HIGHWAY #95 AND COTTONWOOD COVE RD. NEAR THE PC OF THE HIGHWAY #95.
4	6C83 35NW6	1083.304	F N D	RIVET AND SQUARE ALUMINUM PLATE IN SOUTH PORTION OF A CONCRETE GAS PUMP ISLAND, NORTH SIDE OF COTTONWOOD COVE RD., WEST OF NEVADA ST.
5	6C83 36NWW6	1084.219	F N D	RIVET AND SQUARE ALUMINUM PLATE IN NORTHEAST CORNER OF CONCRETE PORTION OF A CATTLE GUARD, COTTONWOOD COVE RD., 0.65 MILES EAST OF CALIFORNIA ST.
6	6C83 35W4	1083.727	F N D	RIVET AND SQUARE ALUMINUM PLATE IN NORTH PORTION OF CONCRETE BASE FOR A FIRE HYDRANT, SOUTH SIDE OF COTTONWOOD COVE RD., BETWEEN MAIN AND LINCOLN STREETS.
7				LOST 1992
8	6C83 35W6	1080.516	F N D	RIVET AND SQUARE ALUMINUM PLATE IN EAST PORTION OF A CONCRETE FLAG POLE BASE IN FRONT OF THE FIRE STATION, WEST SIDE OF NEVADA ST. BETWEEN HILL AND ENCINITAS STREETS.
9	6C83 35SW6	1080.224	F N D	2" DOME HEAD BRASS CAP IN A SURVEY WELL, CENTERLINE PI OF NEVADA AND SURPRISE LODGE STREETS.
10	6C83 34E4	1078.327	F N D	RIVET AND SQUARE ALUMINUM PLATE IN TOP OF CURB, NORTHEAST CORNER OF HOBSON ST. AND HIGHWAY #95 NEAR THE PC OF THE HIGHWAY #95 .
11	6C83 35SWW6	1081.582	F N D	2" DOME HEAD BRASS CAP IN TOP OF CURB, NORTHWEST CORNER OF HOBSON ST. AND MAIN ST. ALSO STAMPED "1986 42.15 RLS 5835"

### CLARK COUNTY VERTICAL CONTROL v.2003

CLARK COUNTY SURVEYOR'S OFFICE  
5051 SOUTH PARADISE ROAD  
LAS VEGAS, NEVADA 89119  
(702) 455-0640

CONVERSION FACTOR:  
METERS X  $\left(\frac{3937}{1200}\right)$  = U.S. SURVEY FEET

REVISED 2003

SHEET  
1 OF 2

**28-63**  
**SE**

No.	STATION	ELEVATION (METERS)	DESCRIPTION	No.	STATION	ELEVATION (METERS)	DESCRIPTION
12	6C83 34SEE6	1081.809	F N D RIVET AND SQUARE ALUMINUM PLATE IN TOP OF CURB, NORTHEAST CORNER OF THE HIGHWAY AND GAVILAND ST. NEAR THE PC OF THE HIGHWAY.	25			
13	6C83 35SWS	1086.772	F N D RIVET AND SQUARE ALUMINUM PLATE IN TOP OF CURB, EAST SIDE OF THE HIGHWAY, 10' NORTH OF THE SOUTH END OF CURB, 750' SOUTH OF GAVILAND ST.	26			
14	STATE CLS 104	1078.878	F N D 1 1/2" ALUMINUM CAP, MARKED NEV. HWY. CLS 104, 30' WEST OF WEST HIGHWAY E.O., 2700' SOUTH OF COTTONWOOD COVE RD. 28.5' SOUTH OF "25 M.P.H." FLASHING YELLOW WARNING SIGN ON THE SOUTH SIDE OF TOWN.	27			
15	K 315 1949	1067.508	F N D 4" USC&GS BRASS CAP IN A (6' X 4') BOULDER, 350' SOUTH OF HOBSON ST. AND 150' EAST OF WASHINGTON ST. STAMPED "K315 1949"	28			
16	V 303 1949	1067.142	F N D USC&GS BRASS CAP, IN A (2' X 3') BOULDER, WEST OF HIGHWAY #95 ALONG STATE ROUTE 164, 90' SOUTH OF MILE MARKER 18. 45' SOUTHWEST OF PP # (P92817) STAMPED "V303 1949".	29			
17	0C83 34S6 2000	1057.442	S E T RIVET AND ROUND ALUMINUM PLATE IN A CONCRETE FOOTING FOR A MILL, 3200' WEST OF HIGHWAY #95 AND 85' NORTH OF HOBSON ST. 135' NORTHWEST OF PP #P92815.	30			
18	0C83 34C4 2000	1069.158	S E T RIVET AND ROUND ALUMINUM PLATE IN A CONCRETE FOOTING FOR A SIGN, (SIGN MISSING) 20' SOUTH OF THE E.O. S.R. 164, AND 1700' WEST OF THE PI OF S.R. 164 AND HIGHWAY #95.	31			
19	0C83 35N6 2000	1078.155	S E T RIVET AND ROUND ALUMINUM PLATE IN A CONCRETE FIRE HYDRANT BASE, SOUTHWEST CORNER OF WASHINGTON ST. AND COTTONWOOD COVE RD.	32			
20	0C83 35E4 2000	1085.608	S E T RIVET AND ROUND ALUMINUM PLATE IN TOP OF CURB, NORTH SIDE OF COTTONWOOD COVE RD. AND 1770' EAST OF WASHINGTON ST. NEAR THE EAST ENTRANCE TO THE SEARCHLIGHT JUSTICE COURT, 3' FROM S. END OF CURB.	33			
21				34			
22				35			
23				<b>CLARK COUNTY VERTICAL CONTROL v.2003</b>			
24				CLARK COUNTY SURVEYOR'S OFFICE 5051 SOUTH PARADISE ROAD LAS VEGAS, NEVADA 89119 (702) 455-0640		CONVERSION FACTOR: METERS X $\left(\frac{3937}{1200}\right)$ = U.S. SURVEY FEET	
				REVISED 2003	SHEET 2 OF 2	<b>28-63 SE</b>	